

Oct. 1925
LARKSVILLE
PA.

SCALE 100 FT TO AN INCH
(ENTIRE SHEET)

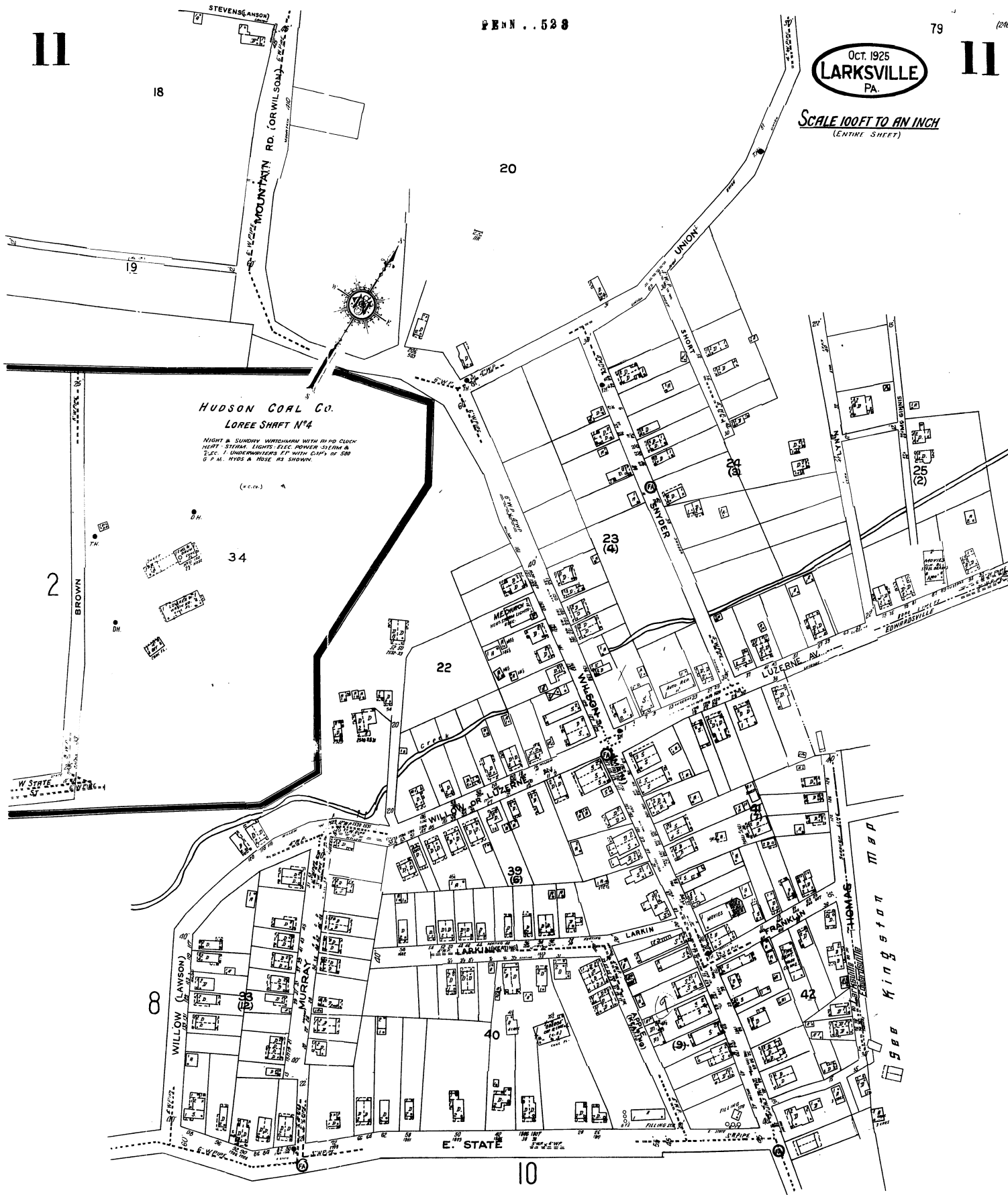

HUDSON COAL CO.
LOREE SHAFT N°4

NIGHT & SUNDAY WORKING WITH 11:00 CLOCK
HEAT STIRRA, LIGHTS, ELEC. POWER, STEAM &
ELEC. V. UNDERMINE, FF WITH 2 1/2" OF 500
G.P.M. HYDS & HOSE AS SHOWN.

(C.C.A.)

Scale 100 Ft to One Inch.

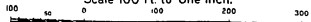

Copyright 1925 by the Sanborn Map Co.