



# The Delaware, Lackawanna & Western Railroad Co.

Report of Side Track Laid at Winton Branch Division, Month of February 1903.

AMOUNT.		RATE.	COST.
1873	Feet at <u>Winton Branch</u> Station—Name or number of track <u>Tracked and</u>		
	<u>Crossover at Mt. Vernon Washery</u>		
1466	Feet of rail used—Height <u>4 1/16"</u>		
1544	" " " " " <u>4 1/16"</u>		
736	" " " " " <u>4 1/2"</u>	38.31 tons	22.00 842 82
376	Track ties—Kind <u>Gab</u>	<u>New</u>	<u>40</u>
308	" " " <u>Chest</u>	"	<u>157 92</u>
	" " " "		<u>354 107 80</u>
	Sets switch ties—Kind	Ft. B. M.	
	Head blocks—Size		
3	Frogs—No. <u>8</u> Length <u>12'</u> Height of rail <u>4 1/16"</u> <u>New</u>		
6	Guard rails—Height of rail <u>4 1/16"</u> Length <u>7'6"</u>		
54	Guard rail braces—Kind <u>4 1/2"</u>		
12	Guard rail fillers—5 inch		
12	" " " 4 1/2 inch		
12	Guard rail filler bolts—Size <u>9" x 3/4"</u>		
	Switch stands—High	Style	
3	" " " Low	<u>Century</u>	
3	Pairs of Switch points—Height <u>4 1/16"</u> Length <u>15'</u>		
54	Split switch side plates		
3	Split switch connection rods—Length		
	Stub switch connection rods—Length		
	Stub switch spread rods		
9	Split switch spread rods		
54	Pair—Angle bars—Size <u>4 1/16"</u> <u>2nd Class</u>		
51	" " " " <u>4 1/2"</u>		
28	" Fish plate splices		
6	" Offset splices—Size <u>4" - 4 1/2"</u>		
2	" " " " <u>4 1/2" - 4 1/16"</u>		
	Tie Plates		
564	Track bolts—Kind and size <u>4" x 3/4"</u> <u>New</u>		
	Nutlocks—Kind and size		
1368	Pounds of track spikes		
	Cost of labor grading, by Company men		181 82
	" " " " paid by voucher		
	" " " laying		90 91
	" " " surfacing		90 91
	Total cost of siding		
	Proportion of cost to be charged to other parties		

When second-hand material is used, note same on report.

Make sketch of side track laid on back of report, giving distance head-block is from some known point.

Give number of feet of above track on Railroad Company's property, and number of feet on outside property with name of person to whom property belongs.

THE DELAWARE, LACKAWANNA & WESTERN R. R. CO.

REPORT OF SIDE TRACK LAID.

Month of ..... 190 .....

at ..... Station .....

..... Division .....

..... Roadmaster. ....

Property of Temple Iron Co

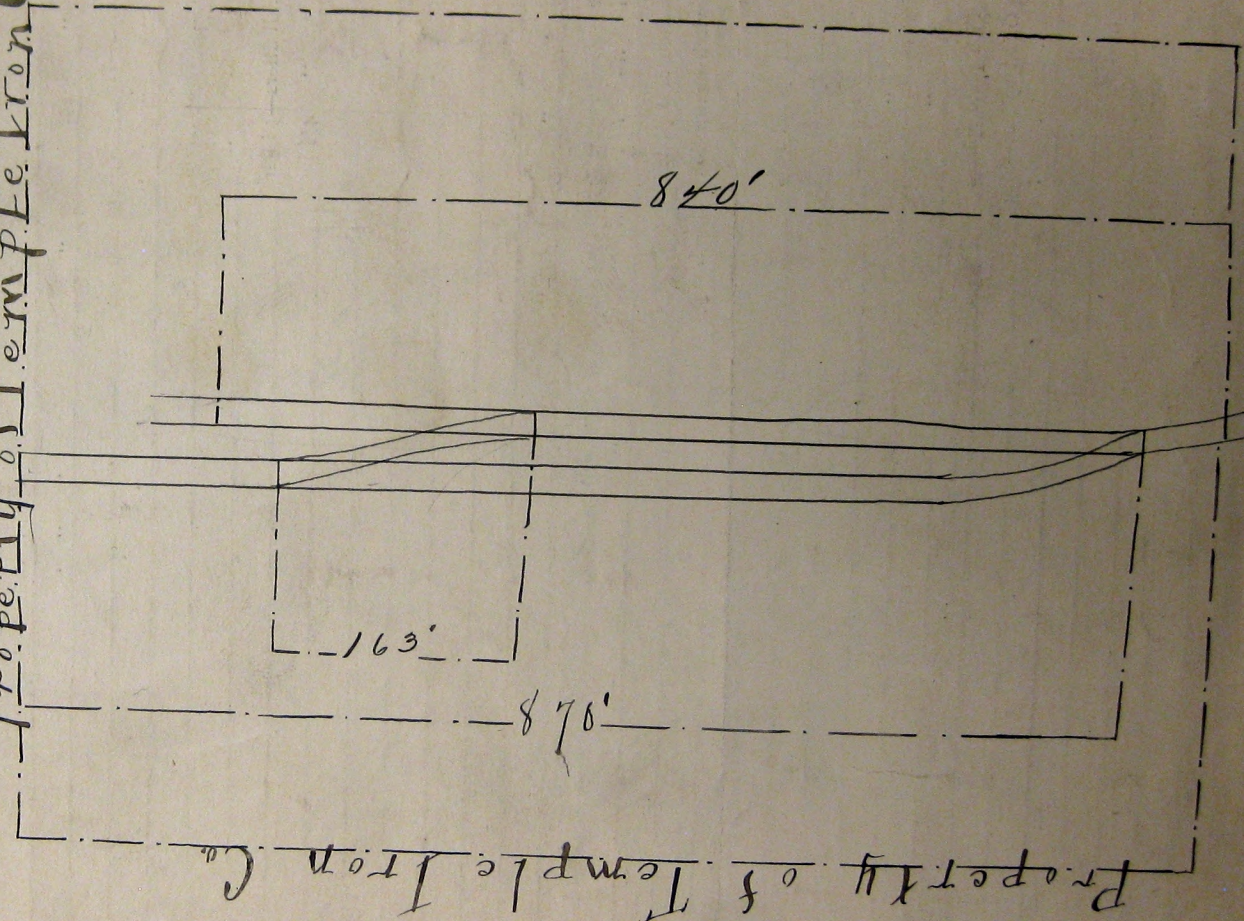

Property of Temple Iron Co

# The Delaware, Lackawanna & Western Railroad Company,

File No. 214

767 feet of *DLW Track leading to M. Vernon Washby Abandoned* at *Winton Branch*

Main Line - Low, Division *September*, 191*3*

*Abandoned Dep. etc*

		RATE	AMOUNT	COST
Engineering				
Grading, Company labor, Foreman hours				
" " " Laborers hours				
" " Material				
" Contract				
" Department				
" "				
Total Grading				
Track Ties	Kind			
" "				
" "				
" "				
Sets Switch Ties	No.	F. B. M.		
" " "				
" " "				
Total Ties				
Feet <del>New</del> Usable Rail	1221 Tons	55 # Size Rail \$50.00	244.20	
" " " " "				
" " " " "				
" " " " "				
Total Rails				244.20
Switch Stands, New or Usable		Scrap		
" " " " "				
" " " " "				
Pairs Switch Points, Complete, New or Usable	LENGTH 15'	Scrap		
" " " " "				
Slip Switch, Complete, New or Usable	No.			
" " " " "				
Frogs, New or Usable	No. 12'	Scrap		
" " " " "				
Guard Rails, Complete, New or Usable		Scrap		
" " " " "				
Derail, Complete, New or Usable				
Total Frogs and Switches				
Pairs Angle Bars, New or Usable		Scrap		
" " " " "				
" " " " "				
Pairs Insulated Joints, New or Usable				
" " " " "				
" " " " "				
Pairs Offset Joints, New or Usable		Scrap		
" " " " "				
Tie Plates, Plain, Intermediate, New or Usable		Scrap		
" " " Joints " " "				
" " " Shoulder Intermediate " " "				
" " " " " " " "				
" " " Joints " " "				
" " " " " " " "				
Track Bolts, New or Usable		Scrap		
" " " " "				
Nut Locks, New or Usable		Scrap		
" " " " "				
Lbs. Track Spikes Cut, New or Usable		Scrap		
" " " " Screw, " " "				
Rail Creepers, New or Usable				
" " " " "				
Bumping Posts				
" " " " "				
Tons or Yds. Ballast				
" " " " "				
Total Ballast				
Track <i>taking up</i> <del>Laying and Surfacing</del> , Foreman hours	59 (5.9 days)	\$67.50	13.28	
" " " " " Laborers hours	290	.16	47.20	
Laying and Surfacing				60.48
Total <i>taking up</i>				304.68
Total Cost				304.68
Charged Others				
Net Cost				304.68
Completed <i>September</i>	Account			
Length on Railroad Land <i>710</i>	Feet			
Length on Other's Land <i>767</i>	Feet <i>on land of M. Vernon Washby</i>			

Sketch to be Drawn Below Showing Layout.

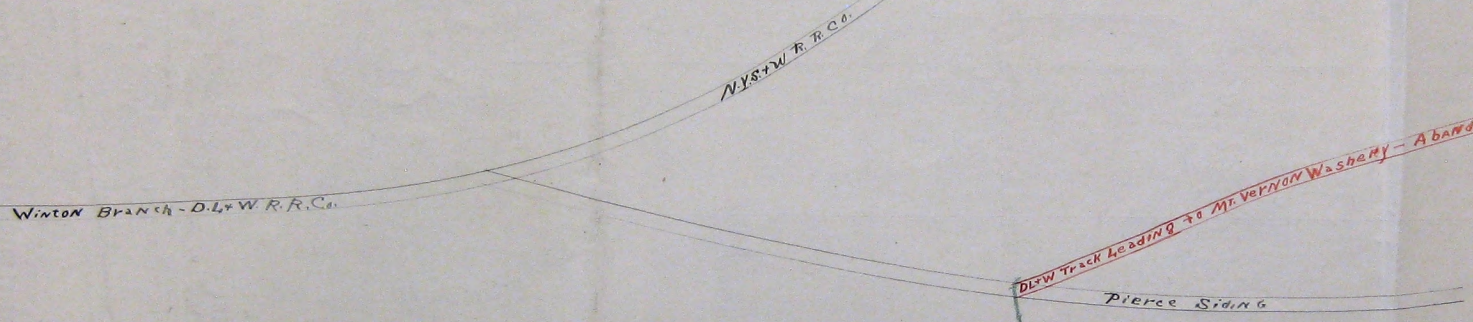

Name Track		Date Built		Address	
Location	Form Served	ORIGINAL	EXTENSION	ORIGINAL	EXTENSION
Total Length				Length of Track on Trestle	
Length in Clear				Weight of Rail	
Ft. on R. R. Land				Kind of Frog	
Ft. off R. R. Land				Yards or Grading	
Total Cost				Maximum Curve	
Paid by D. L. & W.				Grade	
" " Outsider				Kind of Ties	
Ft. owned by D. L. & W.				" " Sw. Timber	
" " Outsider				Derail	
Maintained by				Bumping Post	
Private Track				Bridge	
Date Extended				Pipes or Culverts	
Date Removed				The Plates	
Rail and Fastenings owned by				Kind of Ballast	
Ties owned by				" " Spikes	
Length of Track on Main Stem					
" " of " "					
Form 64					



# The Delaware, Lackawanna & Western Railroad Co.

Report of Side Track Laid at Mr. Vernon on Main Line Division, Month of February, 1903

AMOUNT	DESCRIPTION	RATE	COST
1873	Feet at <u>Winton Branch</u> Station—Name or number of track <u>New Tracks and</u>		
1466	Feet of rail used—Height <u>4 1/16"</u>		
1544	" " " " " <u>4 1/2"</u>	22.00	842 82
736	" " " " " <u>4"</u>		
45	" " " " " <u>4 1/16"</u> <u>55</u> <u>Guard Rails</u>		12 10
669	Track ties—Kind <u>Oak, Second</u>	40¢	267 60
308	" " " <u>Check.</u>	30¢	92 40
	Sets switch ties—Kind <u>Ft. B. M.</u>		
	Head blocks—Size		
3	Frogs—No. <u>8</u> Length <u>12'</u> Height of rail <u>4 1/16"</u>	16.15	48 45
	Guard rails—Height of rail		
54	Guard rail braces—Kind <u>4 1/2"</u>	20¢	10 80
12	Guard rail fillers—5 inch	13¢	1 56
12	Guard rail filler bolts—Size <u>7/8" x 8"</u>	4¢	48
3	Switch stands—High <u>Century</u>	9.00	27 00
3	Pairs of Switch points—Height <u>Power</u> Switches, complete, <u>4 1/16"</u>	20.00	60 00
54	Pair—Angle bars—Size <u>4 1/16"</u> <u>Second class</u>	45¢	24 30
51	" " " " " <u>4 1/2"</u>	35¢	17 85
28	" Fish plate splices <u>Second class</u>	15¢	4 20
6	" Offset splices—Size <u>4 1/2" to 4"</u>	40¢	2 40
2	" " " " " <u>4 1/16" to 4 1/2"</u>	50¢	1 00
564	Track bolts—Kind and size <u>4 1/8"</u> <u>WASHERY</u>	3¢	16 92
15 cars	Nutlocks—Kind and size <u>Cinders</u>	5.00	75 00
1368	Pounds of track spikes	1.84	24 62
	Cost of labor grading, by Company men <u>Jan'y</u> <u>32.85</u>		32 85
	" " " " paid by voucher <u>Jan'y</u> <u>13.32</u>		13 32
	" " " " laying		90 91
	" " " " surfacing		90 91
	Total cost of siding		<del>1928 14</del> 1893 14
	Proportion of cost to be charged to other parties <u>Temple Coal &amp; Iron Co. pay for all labor and Cinders</u>		438 64

*Handwritten notes:*  
 Con not locate  
 Temp for labor

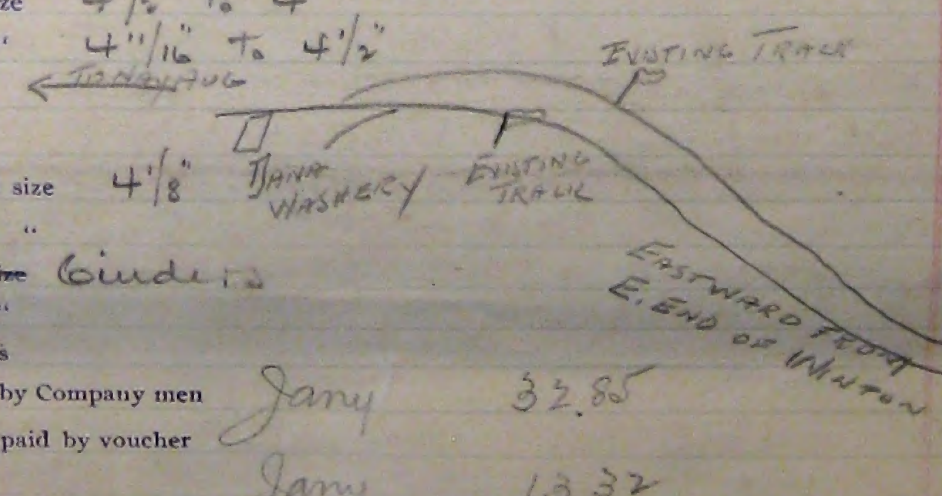

*Vertical handwritten note:*  
 See Abandoned Sidings Report 9/13

*Vertical handwritten note:*  
 Dike Trestle 2/25

*Handwritten initials:*  
 V.P.

*Handwritten number:*  
 2641

1903



# The Delaware, Lackawanna & Western Railroad Co.

Report of Side Track Laid at *W. Jessup* on *Main Line* Division, Month of *February* 190*2*

*Correspondence attached please* *My A/R's file 11-515*

AMOUNT.	DESCRIPTION	RATE	COST.
	<i>Winton 1312</i>		
217	Feet at <i>Winton Branch</i> Station—Name or number of track <i>Connection with Winton Branch and Otterick Creek Branches for Temple Iron Co.</i>		
314	Feet of rail used—Height <i>4 1/2</i> } <i>4.20 ton</i>	22.00	9240
120	" " " " " <i>4</i>		
15	" " " " " <i>4 1/2</i> } <i>Guard Rails</i>		330
14	Track ties—Kind <i>Oak</i> <i>seconds</i>	40¢	560
89	" " " " <i>Chesr.</i>	30¢	2670
1	Sets switch ties—Kind <i>Oak</i> Ft. B. M. <i>2378 ft.</i>	17.00	4043
1	Head blocks—Size		
	Frogs—No. <i>8</i> Length <i>12'</i> Height of rail <i>4 1/16</i>		1615
	Guard rails—Height of rail Length		
18	Guard rail braces—Kind <i>4 1/2</i>	20¢	360
4	Guard rail fillers—5 inch		
4	" " " <i>4 1/2</i> inch	13¢	52
4	Guard rail filler bolts—Size <i>7/8" x 8"</i>	4¢	16
1	Switch stands—High Style <i>Ramapo - 2nd class</i>		1000
	" " Low		
1	Pairs of Switch points—Height Length <i>Power Switch, complete, 4 1/16</i>		2000
	Split switch side plates		
	Split switch connection rods—Length		
	Stub switch connection rods—Length		
	Stub switch spread rods		
	Split switch spread rods		
11	Pair—Angle bars—Size <i>4 1/2</i> <i>second class</i>	35¢	385
4	" " " " <i>4</i>	30¢	120
2	" Fish plate splices		
2	" Offset splices—Size <i>4 1/16 to 4 1/2</i>	50¢	100
	" " " " <i>4 1/2 to 4</i>	40¢	80
76	Tie Plates		
	Track bolts—Kind and size <i>4 1/8</i>	3¢	228
6 cars	Nutlocks—Kind and size <i>Binders</i>	5.00	<del>3000</del>
366	Pounds of track spikes	1.3¢	657
	Cost of labor grading, by Company men		3040
	" " " " paid by voucher		
	" " " " laying		9159
	" " " " surfacing		3039
	Total cost of siding		<del>42806</del>
	Proportion of cost to be charged to other parties		41696
	<i>Temple Coal &amp; Iron Co. pay for all labor and binders</i>		18238
			23458

*Map no 7 no number*

*(U.R.)*

*On Temple Iron Co. property.*

*April account - 1903*

*(1642)*

## The Delaware, Lackawanna &amp; Western Railroad Co.

STROUDSBURG, PA. FEB 26 1903

Mr. A. J. Neafie,  
Priv. Asst. Engr.,  
Hoboken, N. J.

Dear Sir:-

Referring to attached  
report covering construction  
of tracks for Temple Iron  
Co. at Mt. Jessup, beg to  
advise that in addition  
to the material and labor  
enumerated on this report,  
there were also furnished  
the following cars of ashes  
and engine and crew in



# The Delaware, Lackawanna & Western Railroad Co.

the construction of these tracks:

Lett 99795  
 99784  
 99761  
 99779  
 12507  
 3156

Engineer	50 Miles	@ \$4. <sup>00</sup>	= 2.00
Foreman	50 "	" 2. <sup>40</sup>	= 1.20
Conductor	50 "	" 3. <sup>25</sup>	= 1.63
3 Brakemen	150 "	" 2. <sup>16</sup>	= 3.24
			<hr/>
			98.07

Yours truly,  
 M. Gil  
 Dir. R.M.