

250

220

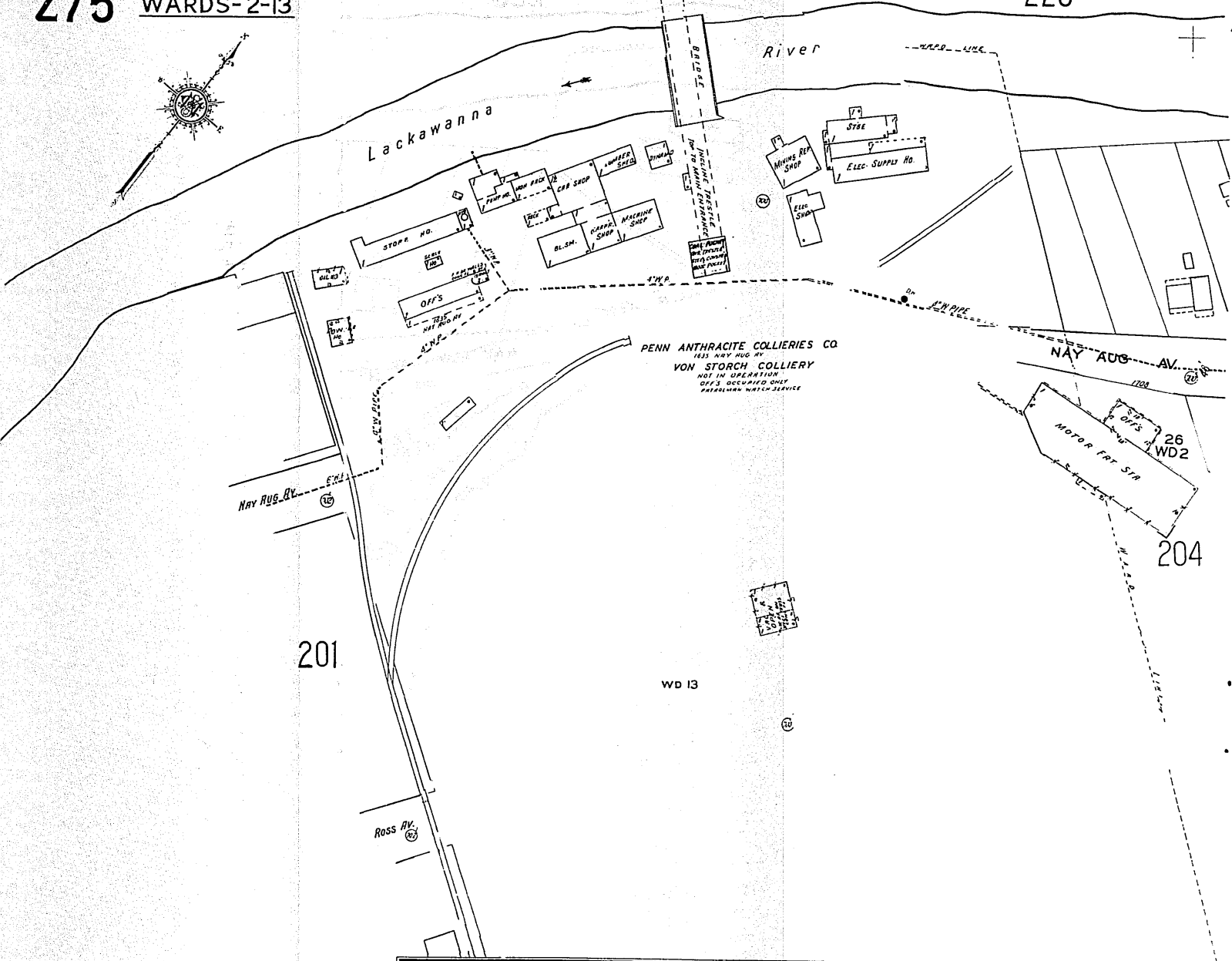
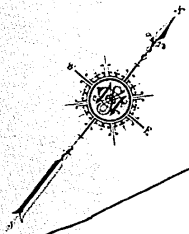

PENN ANTHRACITE COLLIERIES CO  
1835 NAY AUG AV  
VON STORCH COLLIERY  
NOT IN OPERATION  
OFF'S OCCUPIED ONLY  
FIREALARM WATCH SERVICE

NAY AUG AV

NAY AUG AV

ROSS AV.

201

WD 13

204

204

BLOG. MAIL STGE

THIS DETACHMENT NOT CORRECTED SINCE DEC. 1953

BROOKSIDE  
Located 1/2 mile N of Dalton

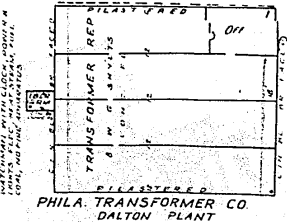
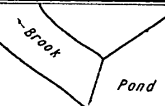

U. S. ROUTE No 11

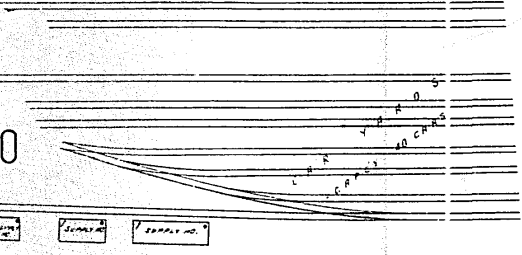
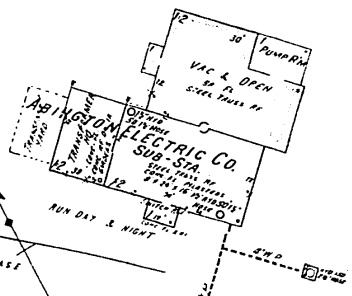

THE LACKAWANNA TRAIL

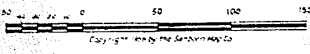

0